

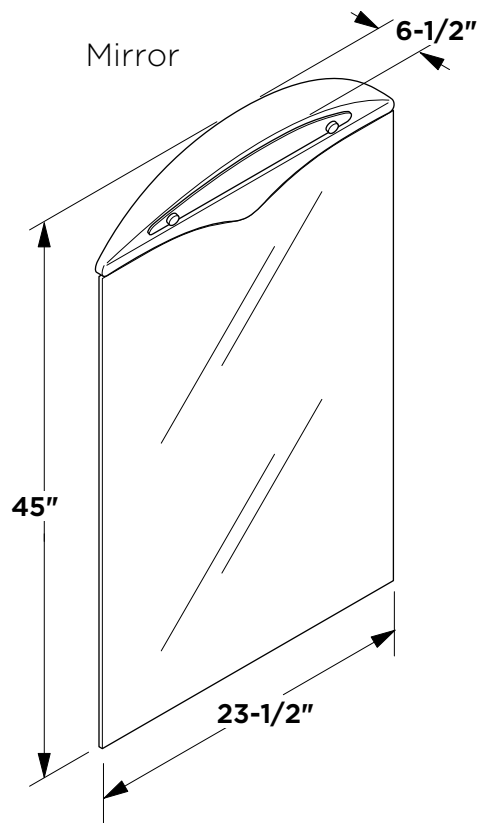

FVN5060
CALMO
INSTALLATION GUIDE

FRESCA™



Vanity Front



FVN5060

Vanity Back

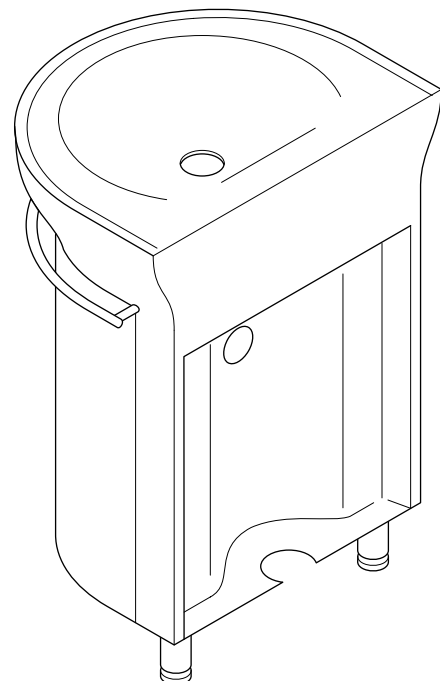
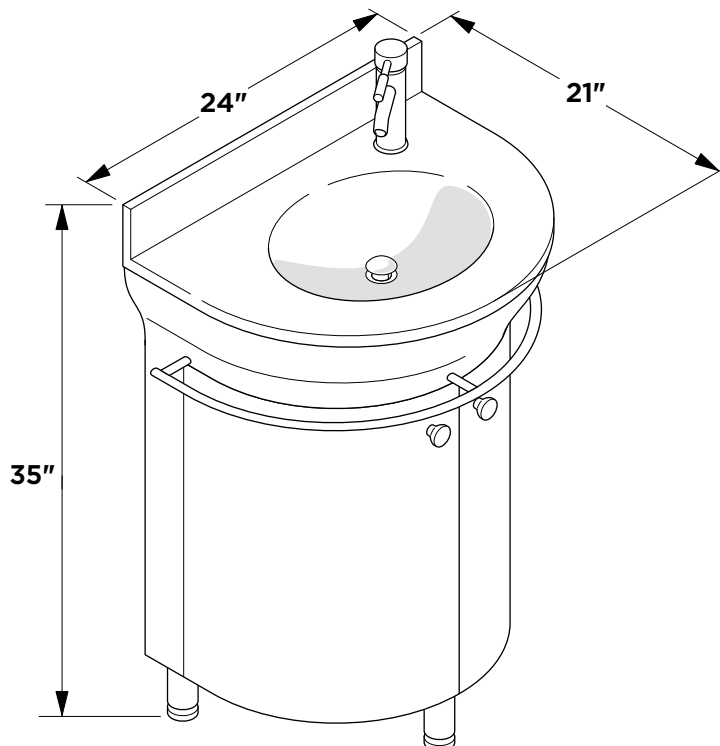

TOOLS FOR ASSEMBLY

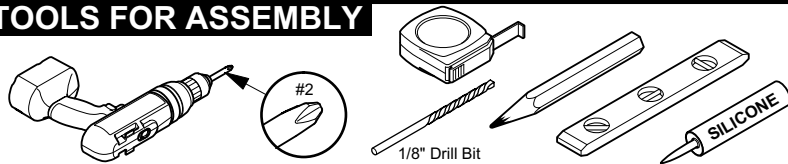

PARTS

IMPORTANT: Consult an expert for the proper screws/bolts to use when attaching to various wall constructions. Screws provided do not attach to all wall construction types.

Mirror

A

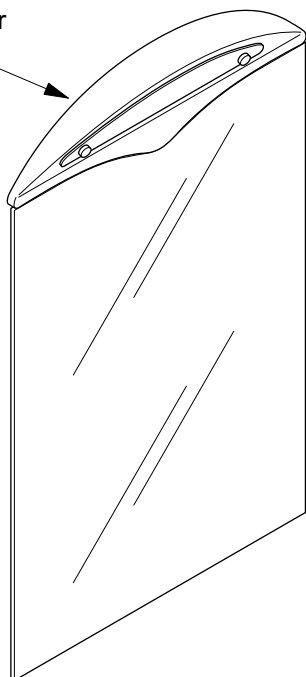

Sink

B

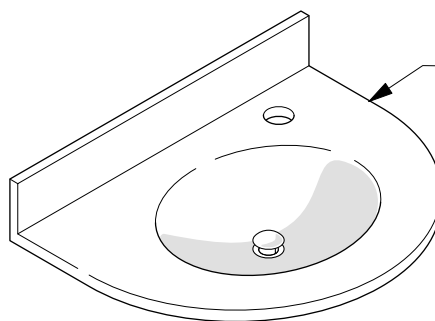

Cabinet

C

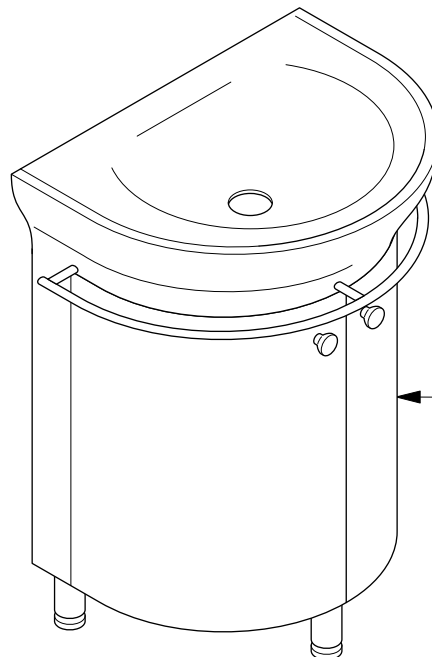

1

Position cabinet (C)

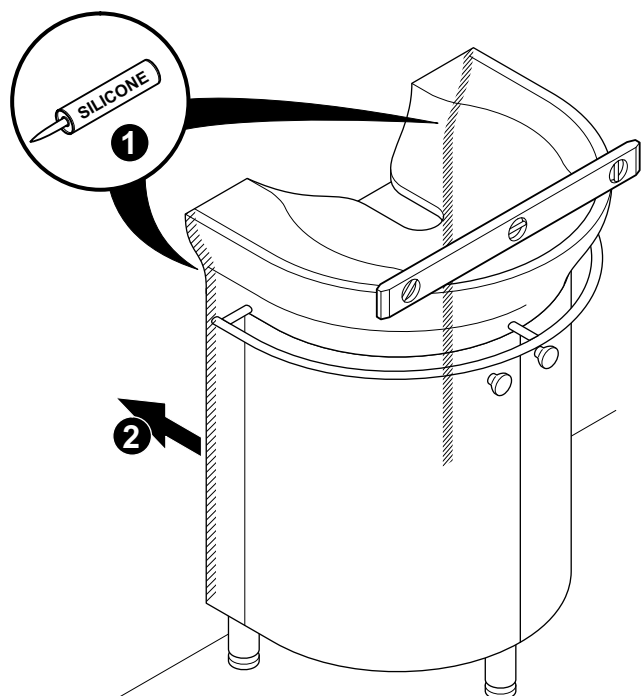

2

Apply silicone and install sink (B)

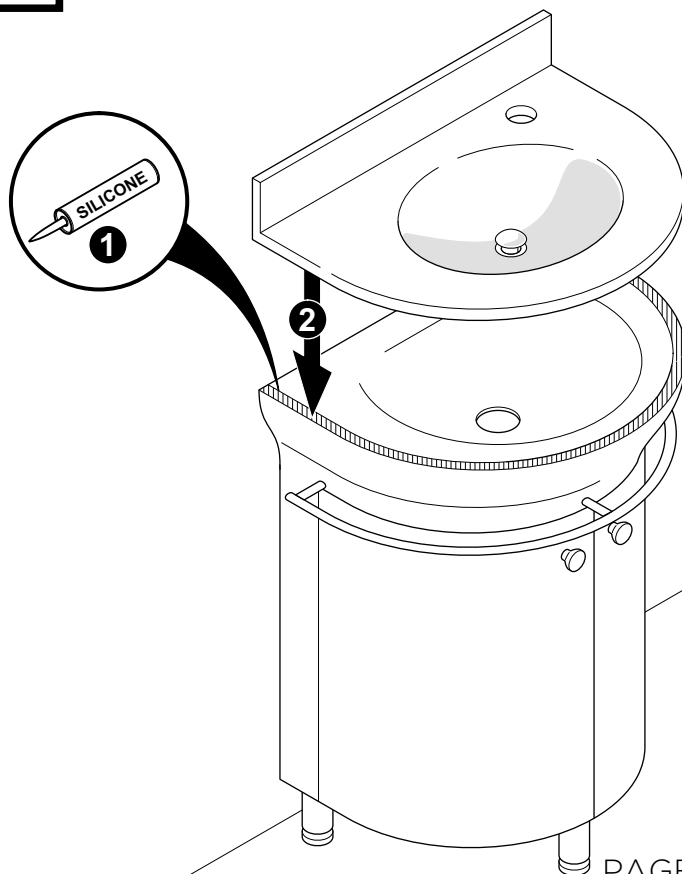

IMPORTANT: Consult an expert for the proper screws/bolts to use when attaching to various wall constructions. Screws provided do not attach to all wall construction types.

